

# Tyent Water Ionizer

## *User's Manual*

Instructions for Models:

- MMP-5050
- MMP-7070
- MMP-7070 T
- MMP-9090 TX



WATER FOR WELLNESS

## To Our Valued Customers

Thank you for purchasing a **Tyent MMP Series** Water Ionizer. This User's Manual can be used with these units: **MMP-5050, MMP-7070, MMP-7070 TURBO and MMP-9090 TURBO EXTREME**. Please check the unit you have purchased since some features may vary.

This product is intended for domestic use only. Please read all safety warnings and this User's Manual carefully before using this product to ensure proper product usage. (Keep the manual handy for easy reference.)

- We are not responsible for any accidents and/or malfunctions due to the improper use of this machine.
- Please keep the manual and warranty card (enclosed) in a safe place, so that it's easily accessible when you need it.
- Please refer to this manual often when you have questions during the use or when troubleshooting this unit.

## Intended Use

This device creates **functional alkaline, ionized water**. It changes the properties of regular tap water through the use of electrolysis. Following are the changes normal tap water undergoes via this process:

- An increase or decrease in pH level
- Creation of negatively charged hydrogen ions (anti-oxidants)
- Smaller water molecule clusters for better absorption
- An increase in oxygen
- Purification through filtration



mmpseries | user's manual

# Table of contents

To Our Valued Customers .....	2
Precautions Before Use .....	4
Safety Precautions and Warnings.....	5
Water Ionizer MMP Series Unit Specifications .....	7
Product Features.....	8
Package Contents .....	9
Tools you will Need .....	10
Unit Overview .....	11
How to Install the Unit.....	12
Water Hose Installation .....	14
LCD Display and Touch Pad Overview.....	16
Directions for Product Use.....	17
TURBO Function .....	20
Customer Serviceable Parts .....	22
Cleaning Your Tyent Unit .....	24
Recommedations for Using this Unit .....	25
Other Icon Displays .....	27
Troubleshooting.....	28



## Precautions Before Use

Safety precautions are provided for the safe and proper use of this unit and can prevent danger, bodily harm and/or possible damage due to misuse. Please make sure you are familiar with all the safety precautions and warnings associated with this unit.

**PLEASE FOLLOW ALL INSTRUCTIONS WHEN YOU DRINK WATER CREATED BY ELECTROLYSIS FROM THIS UNIT.** (*Hereinafter referred to "functional water"*)

1. Always consult your primary care physician before drinking functional water. If you are a first-time drinker, only drink a small amount for the first week near a neutral pH level. This will give the body time to adjust to functional water during the detoxification period.
2. Do not drink functional water with medication. Use filtered water instead.
3. If you notice any negative effects from drinking functional water, stop drinking immediately and consult with your primary care physician about changes in your body's pH level.
4. If you are currently under the care of a primary care physician for an existing condition, consult with your primary care physician about how changes in pH and other characteristics of functional water could affect your condition.
5. If you suffer from gastric anacidity, kidney failure or potassium excretion, you should not drink functional water.
6. Verify the pH levels of the functional water dispensed from this unit on a monthly basis to ensure proper function. This can be done with the supplied reagent drops and a pH color chart.
7. When switching from one pH to another, it is good practice to let the water run for several seconds before using.
8. It is common to drink half your body weight in ounces. For example, if you weigh 180 pounds, it may be wise to drink 90 ounces of water per day. This especially applies after you have given your body some time to adjust to the new pH level.
9. 9.5 to 9.8 pH is the recommended drinking level for functional water. It is not recommended to drink functional water above 10 pH.
10. If you wish to store functional water, use a glass, stainless steel or other non-leaching material with an airtight lid and store in the refrigerator. Functional water will begin to weaken immediately and loses most benefit after 3 days.
11. Never run hot water through this unit.
12. Never drink acidic water.
13. It is recommended that you use municipal water as source water (raw water). **DO NOT** use well water without first consulting the **TYENT USA** Service Center, as this could void the warranty. Service Center Phone: **855-TYENT-USA (893-6887)**



mmpseries | user's manual

# Safety Precautions and Warnings



## CAUTION:

### RISK OF FIRE AND ELECTRIC SHOCK



Do not use if the power cord is damaged or in a loose power outlet.



Do not pull the power cord. Never touch power cord or power outlet with wet hands.



Do not use power surge protectors with this unit. Use unit with its own dedicated power source.



Do not forcibly bend, squeeze, damage or crush the power cord under heavy objects.



Unplug the power cord during general maintenance, repair, inspection and while replacing parts.



Only use the unit with the correct voltage.



To reduce the risk of electric shock, do not remove cover; no user-serviceable parts inside. Refer servicing to qualified service personnel. Removing the cover will void the warranty.



Do not spray water on the main unit. Do not clean with a damp cloth, benzene or other chemicals, which may leak into the unit.



Do not place this unit near heat sources.



Do not connect water line to a hot water supply.



Do not use unfit raw water in accordance to the standards of the water service act.



Do not use in areas of high humidity and/or high temperature.



Do not place this unit on an uneven surface. Do not drop or use excessive force on this unit.



Place this product near a sink and always allow water to drain into the sink.

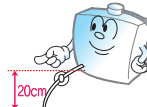

Place acidic water outlet hose within the height of the unit. Make sure the end of the hose is placed less than 8 inches (20 cm) from the bottom of the unit.



When moving the unit, please be sure not to drag by the power cord as this could cause electric shock.



Please be sure to keep the power cord dust free



Do not place ANY objects on top of this unit regardless of how small.

These safety precautions and warnings are provided at **YOUR** benefit to your health and home. Tyent USA is not responsible for any damage or injury caused by not adhering to these precautions and warnings.



Carefully remove this unit from packaging. Keep original packaging for future storage and unit transportation.

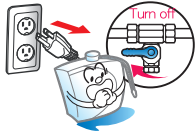

In case water leaks out of the unit (other than hoses) or unit is standing in a puddle of water, shut off the water supply, unplug the power cord and refer servicing to qualified service personnel.



In case of strange noises, burning odor or smoke, unplug the power cord immediately and refer servicing to qualified service personnel.



Replace filters every 6 months to optimize the purification performance of this unit even if the replacement indicator light isn't turned on.



In the case where the unit isn't used over a long period of time, shut off the valve and unplug the power cord.



Do not poke or scratch the touch pad or LCD display with sharp objects.



If the unit is not used for a few days, let the water run for 1-2 minutes before drinking functional water.

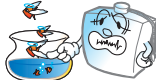

Do not use alkaline or acidic water in fish bowls or aquariums. The sudden change in pH could be harmful or fatal to some marine life.

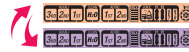

It is beneficial for the maintenance of the machine to run a strong acidic level for a period of 5 minute cycles twice weekly. This will help to maintain a clean chamber.



It is normal for condensation to be present on the unit during humid summer months. If condensation persists despite weather conditions, unplug the power cord and refer servicing to qualified service personnel.



Remove the filters and turn them upside down to remove excess water before storing.



Store unit in its original packaging in a cool, dry place when not in use.



In case the original packaging is not available, cover the unit in plastic to avoid scratching the surface.



Do not store unit near chemicals, food, metals or medication.



In the event that water gets into the power supply, unplug the power cord and completely dry power outlet.

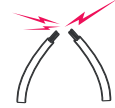

Do not reconnect or splice a defective power cord as it could result in electric shock or become a fire hazard.



Do not plug and unplug power cord repeatedly.



# Water Ionizer MMP Series Unit Specifications

Specification	MMP-5050	MMP-7070	MMP-7070 T	MMP-9090 TX
Model Name	MMP-5050	MMP-7070	MMP-7070 TURBO	MMP-9090 TURBO EX
Purifying Mode	TM Filtration Mode			
Rated Voltage	100-240V a.c. 50/60Hz			
Power Consumption	Max 85W	Max 280W	Max 280W	Max 375W
Operating Pressure Range	0.1 ~ 0.5 MPa			
Extraction Construction	Flexible Tube			
Additional Function	Electronic Extraction Construction			
Product Size	40.0 x 11.6 x 41.6 cm / 15.7 x 4.5 x 16.3 inches			
Product Weight	5.6 kg / 12.3 Lbs.			
Display Unit Configuration	3-steps alkaline water, water purification, 2-phase acidic water, under cleaning voice, filter replacement display, pH concentration level display			
<b>FILTER MATERIAL</b>				
Filter Configuration	<b>Primary:</b> ACF activated carbon fiber, <b>Secondary:</b> ACF activated carbon, Ceramic			
Replacement Type	Revolving Cartridge			
Filter Life Display	LCD filter replacement display and voice announcement			
<b>ELECTROLYTE CELL</b>				
Pole Size	5.5 x 13.1 cm / 2.2 x 5.2 inches / 0.5T			
Quantity of Poles	5	7	7	9



# Product Features

- 1. Fully automatic system with embedded central processing unit (CPU).** Every aspect of creating functional water is controlled by the CPU chip that automatically finds an optimal operating condition using flow rates and water quality.
- 2. Automatic water flow.** Simply pressing the touch button allows you to start and stop the flow of functional water.
- 3. Voice announcement.** Voice announcement for different functions and safety warnings ensure safe and convenient use.
- 4. Filter replacement cycle.** This unit features a filter life cycle display and voice announcements designed to let you know when it is time to change the filters. Every 6 months is best for optimal performance.
- 5. Sensible and elegant design.** This unit uses a compact and elegant design to blend with the rest of the kitchen appliances.
- 6. Touch LCD display color back light.** The color back light on the LCD display allows you to distinguish alkali water from acidic water.
- 7. Advanced water purification system.** The advanced performance of the primary filter and functional secondary filter enable optimal purifying conditions for tap water.
- 8. Automatic Stop Function.** Five minutes after a function is selected, water outflow will stop to prevent overflow or flooding.
- 9. SMPS type power supply.** A CPU monitors the power that is supplied to different parts of the unit, thereby ensuring efficient performance.
- 10. TURBO function.** (*only in the MMP-7070T & MMP-9090 TX models*) Generates strong acid and alkaline water with sterilizing, anti-bacterial cleaning power.
- 11. Electrolytic antibacterial system.** The energy generated when extracting targeted water inhibits growth of microorganisms. Automatic cleaning helps maintain optimal conditions.
- 12. Automatic Safety Diagnostic Function.** After the installation of the TYENT unit, a safety diagnostic procedure follows to check performance. Voice announcements note when unacceptable conditions arise.
- 13. Safety Functions.** The outflow of functional water stops automatically when raw water is not supplied, preventing the electrolytic cell and power supply unit from being damaged due to current overflow, water from being wasted and accidental water leaks. This function also allows you to set pH and ORP levels according to the amount of water inflow, to distinguish pH from backlight colors and set the auto cleaning function.





# Package Contents

1 Water Outlet Tube

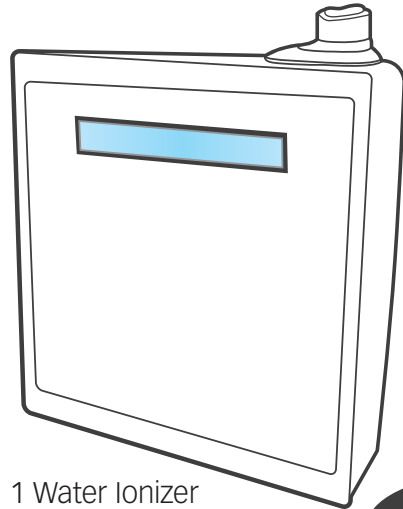

1 Water Ionizer

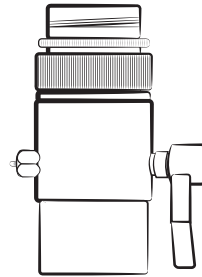

1 Faucet Diverter

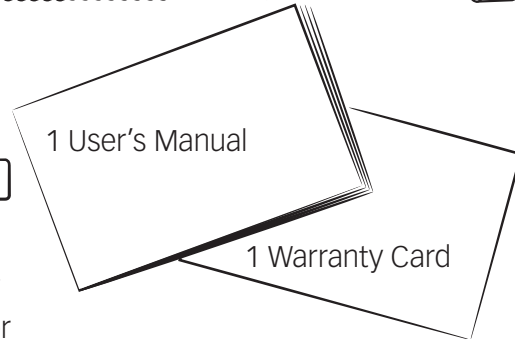

1 User's Manual

1 Warranty Card

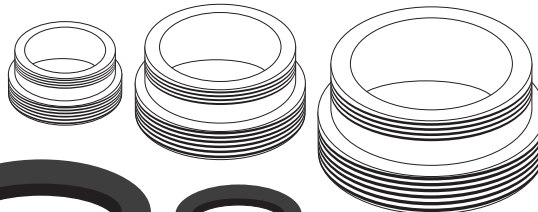

Assortment of Sizers  
and Rubber Washers



1 pH Testing  
Solution Bottle

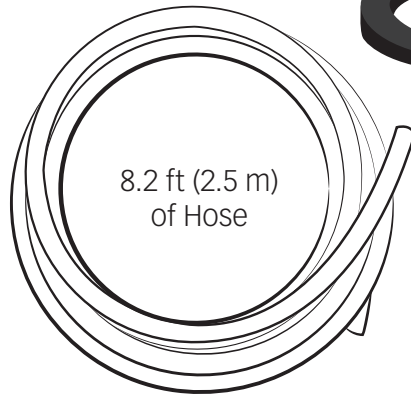

8.2 ft (2.5 m)  
of Hose



2 Tube Suction Cups

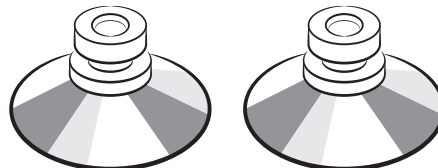

2 Stem Elbows

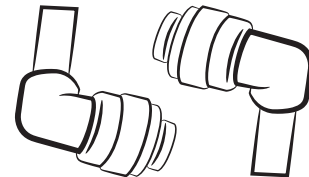

# Tools you will Need

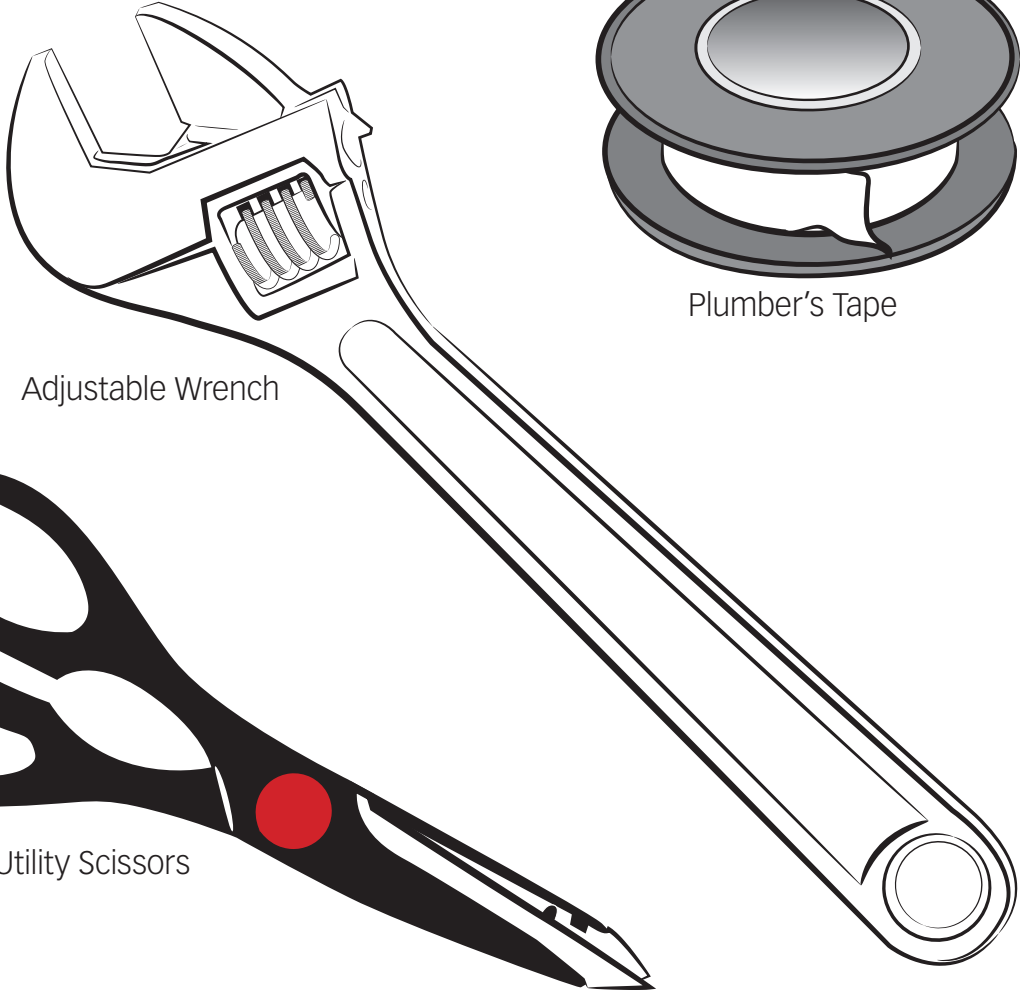

Adjustable Wrench

Plumber's Tape



Utility Scissors



## Unit Overview

Make sure you are familiar with the parts and features of this unit, and carefully read the user's manual and other important information

### Front View Tyent MMP Series

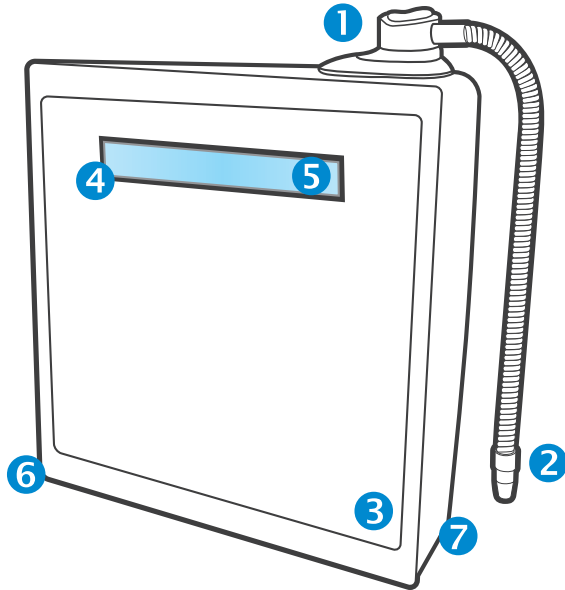

1. Water Outlet Unit
2. Water Outlet Tube
3. Front Cover
4. Operational Touch Pad
5. LCD Display
6. Front Case
7. Rear Case

### Rear View Tyent MMP Series

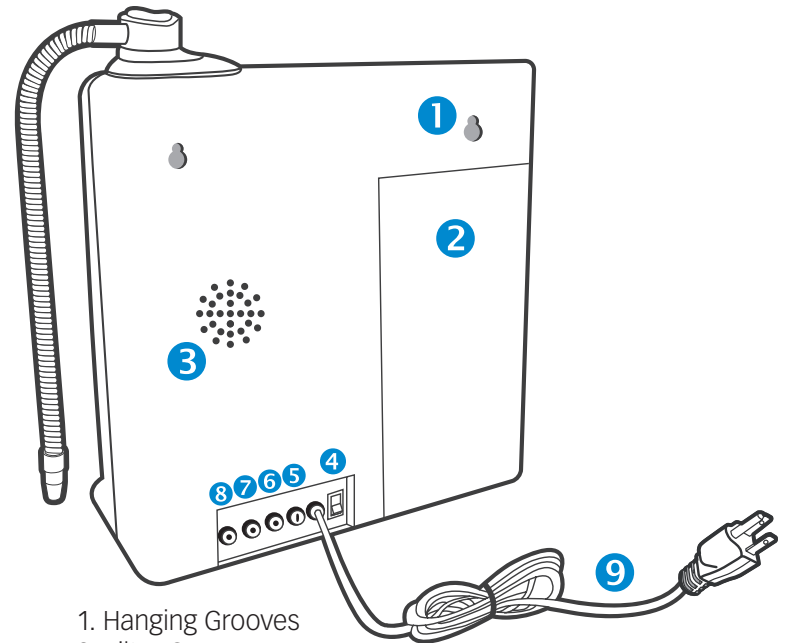

1. Hanging Grooves
2. Filter Cover
3. Speaker
4. Power Switch
5. Fuse
6. Acidic Fitting
7. Source Water Fitting
8. Spare Fitting
9. Power Cord

## How to Install the Unit

Determine if you will connect unit directly to cold water supply line (under-sink) or to faucet (see image)

- Option A – Faucet: Faucet connection requires faucet diverter (included) or
- Option B – Under Sink: Under-sink connection requires under-sink adapter kit (not included) or compatible t-valve (available from most hardware stores)

### Option A – Faucet Installation

Many faucets vary in design, and your faucet may require different setup instructions than those featured in this manual. Please consult a qualified service professional if you are unable to correctly complete the installation. For a video tutorial installation, go to [www.tyentusa.com](http://www.tyentusa.com) for additional instructions.

1. Shut off both hot and cold water main supply at pipe under the sink
2. If your faucet features a screw-on style aerator, remove it by unscrewing it from the tip of the faucet
3. If the included faucet diverter does not fit directly to the tip of the faucet, select an appropriate size connector and rubber washer (included)
4. When connecting diverter or adapter to faucet, be sure to use plumbing pipe thread seal tape (not included) to prevent leaks
5. Connect faucet diverter or faucet diverter (with appropriate connector) to faucet
6. Be sure all connections are secure but do not over tighten

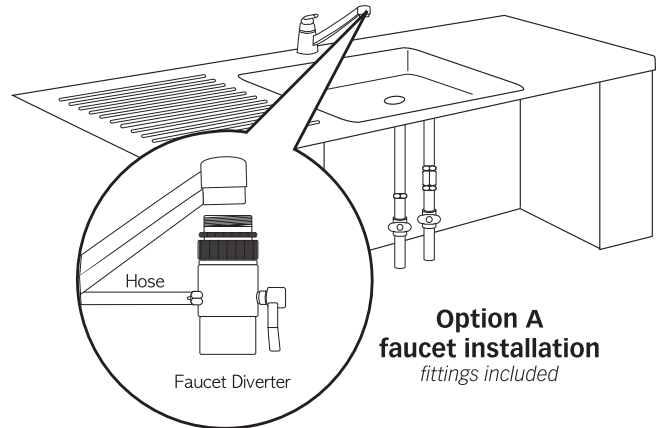

## Option B – Under-Sink Installation

1. Purchase either an under-sink installation kit (not included) or purchase T-connection (with shut-off valve) from a hardware or plumbing supply store. **NOTE:** When unit is not used for an extended period of time (i.e. vacations), the valve should be shut-off to prevent any damage to your unit or home.
2. Shut off both hot and cold water main supply at pipe under the sink
3. Locate the cold water supply line valve
4. Disconnect faucet cold water supply line from main cold water pipe – use towel to catch small amount of water that may come from faucet supply line
5. When connecting T-connection to cold water pipe, be sure to use plumbing pipe thread seal tape (not included) to prevent leaks
6. Reconnect faucet cold water supply line to T-connection (now secured to main cold water pipe)
7. Be sure all connections are secure but do not over tighten
8. Drill a 5/16" hole in your counter-top to accommodate the cold water supply line from the under-sink connection to your water ionizer.

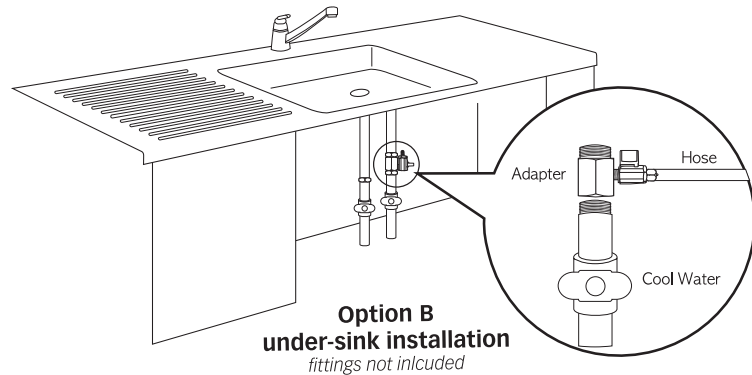

## Both Options

Do not turn on main water supply until all hoses are properly installed to the unit. Unit and components are subject to change without prior notification in order to enhance performance.

Tyent USA is not responsible for any damage to yourself or your home as a result of improper installation or long-term storage procedures. Please consult a qualified service professional for assistance at [www.tyentusa.com](http://www.tyentusa.com) or call the Service Center Phone: 855-TYENT-USA (893-6887)

# Water Hose Installation

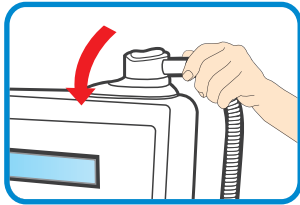

1. Place the unit on the planned installation location and screw the flexible tube clockwise into the water outlet hole positioned at the top of the unit. Do not over tighten.

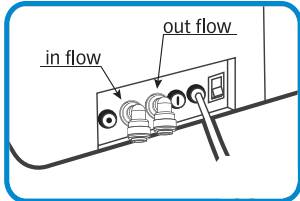

2. Press the stem elbows into the water inflow and outflow holes located on the back of the unit until you hear a click and feel the hose seat firmly in place. Tubing may attach directly, or with elbows (included). **PLEASE NOTE:** When removing tubing or elbows, be sure to push back on small gray flanges located at the outer edge of ports and elbows. Damage can occur if not removed properly!

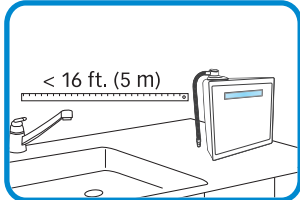

3. Measure between where the unit will be located (on the counter) and the water faucet (or under-sink T-connection) where the diverter (or T-connection) will be installed. Cut enough hose to allow connection from the rear of the unit to the water supply (either faucet diverter or under-sink T-connection). **NOTE:** Keep the length under 16 feet (5 meters) from the unit to the faucet. You may need a pressure pump or larger size hose if the pressure is too low. Be sure to leave a few extra inches (centimeters) of length so the faucet can still be rotated.

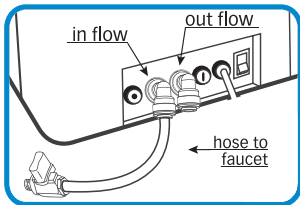

4. Connect the hose from the inflow hole to the cold water supply, either at the faucet diverter (Option A – remove the nut from the diverter, slide the nut on to the hose, firmly seat the hose on the faucet diverter, and screw the nut over the hose and back on to the faucet diverter) or the under-sink T-connection (Option B – route the hose through the counter-top to the T-connection, firmly seat the hose on the T-connection, make sure the connection is sealed completely)

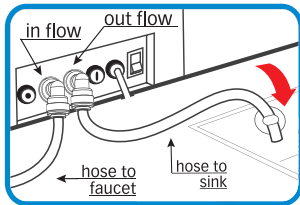

- Cut an appropriate length of drain hose and connect it to the drain on the rear of the unit. Make sure the drain hose is positioned lower than the unit and in the sink to drain properly.

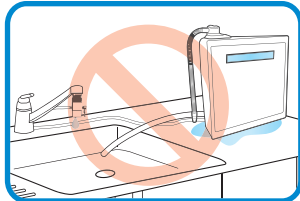

- Make sure all hose connections are firmly seated in the correct holes, both on the unit and at the water supply.

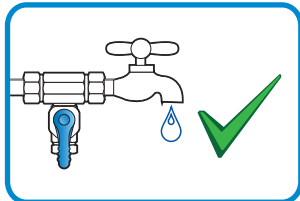

- Turn on the water supply. Make sure there are no leaks at any of the connections. Make sure the faucet is working with both hot and cold water. Make sure there are no leaks from the hose connections on the bottom of the unit. Make sure the hoses are firmly seated in the unit holes.

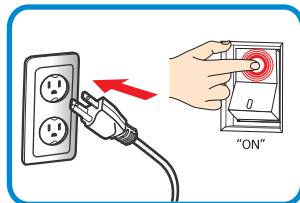

- Plug in the power cord and turn on the unit. You should hear a melody when you power up the unit.

Tyent USA is not responsible for any damage to yourself or your home as a result of improper installation or long-term storage procedures. Please consult a qualified service professional for assistance at [www.tyentusa.com](http://www.tyentusa.com) or call the Service Center Phone: 855-TYENT-USA (893-6887)

# LCD Display and Touch Pad Overview

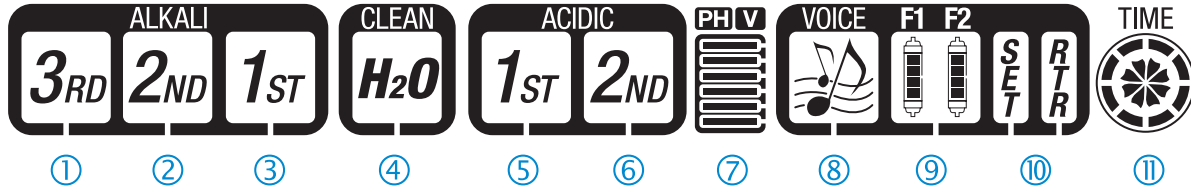

## Touch Pad

- ①. Strong Alkaline Water Mode (Functional Water)
- ②. Medium Alkaline Water Mode (Cooking Water)
- ③. Light Alkaline Water Mode (Drinking Water)
- ④. Purified Water Mode (H<sub>2</sub>O)
- ⑤. Light Acidic Water Mode (Cleaning Water)
- ⑥. Strong Acidic Water Mode (Desinfectant Water)
- ⑦. pH Level / Voltage Level (System Setup Function)
- ⑧. Voice Mode (on/off)
- ⑨. Filter Replacement Indicators
- ⑩. Function Set and Real Time Refresh
- ⑪. Operation Running Time

## IMPORTANT

Backlight of LCD Display will match the pH Level color according to water pH level being used after button is pressed.

Drinkable - Purified H <sub>2</sub> O Water	<b>Green Backlight</b>	
Drinkable - Alkaline Water 1	<b>Blue Backlight</b>	
Drinkable - Alkaline Water 2	<b>Violet Backlight</b>	
Drinkable - Alkaline Water 3	<b>Purple Backlight</b>	
Non-Drinkable – Acidic 1	<b>Yellow Backlight</b>	
Non-Drinkable – Acidic 2	<b>Orange Backlight</b>	





## Directions for Product Use

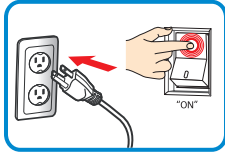

1. When the unit is installed and the power is switched on, the unit will be blinking between purple & red, indicating the Clean Cycle Mode.

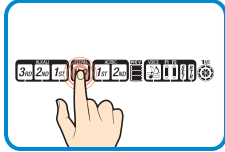

2. The Clean Cycle Mode occurs every time the unit is powered on, after about 12 hours of non-use and after production of about 30 liters (7.9 gallons) of water.

The unit will always blink between purple and red as an indication of the Clean Cycle Mode. This is normal. Simply select your level of Alkaline water, allow 15 seconds for the cleaning cycle to run (after which the water is ready for drinking), and select the same level to stop the flow of water when you are finished.

**NOTE:** A voice announcement saying “**UNDER WASHING**” will occur followed by a distinct melody during the Cleaning Cycle Mode. **DO NOT** drink water during this 15-second period; wait until the melody stops and your selected water begins to dispense.

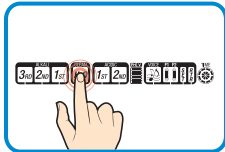

3. Select a desired water mode.

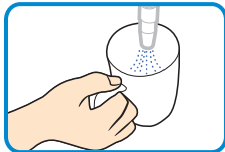

4. Water Outflow: The selected icon flickers during water outflow. If the selected icon is not pressed again, the unit will automatically stop after five minutes of water outflow.

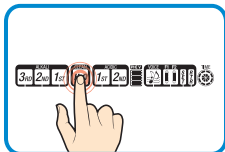

5. Water Outflow Stop: Lightly touch the blinking icon again to stop water flow. **NOTE:** Remember, a **LIGHT TOUCH** is all that is required when pressing the LCD.

## Step by Step Directions for Product Use



**1. Light Alkaline Water – Drinking Water.** Suitable for those just starting to drink alkaline water. Also, suitable for cooking.



**2. Medium Alkaline Water – Cooking Water.** Suitable for middle-stage drinkers. Also, suitable for floriculture and tea brewing (No boiling necessary).



**3. Strong Alkaline Water – Functional Water.** Suitable for end-stage drinkers as well as cooking. The high alkalinity brings out the color in cooked vegetables, makes wonderful rice and cold water tea. It is great for rinsing fresh fruits and vegetables as it helps remove pesticides and wax, and reduces fruit browning.

Please note that alkaline water is absorbed by the body faster than what you are used to drinking. Therefore it has the ability to remove waste from the body more efficiently than you may be used to. Evacuation of toxins through bowel movements, urination and perspiration is a normal reaction to cleansing the body.



**4. Purified Water – Drinking Water.** This is purified water. It has the same pH as your tap water. Take medication with this water only.



**5. Light Acidic Water - Non-Drinkable.** This level most matched the pH on the outside of the body, making it great for washing the skin and shaving. Anti-bacterial properties also make it good for cleaning wounds. Don't forget the pets; it's also great for washing the dog!



**6. Strong Acidic Water - Non-Drinkable.** This water has strong anti-bacterial properties. It is great for cleaning kitchen counters, dish cloths and sponges and rinsing dishes. It also may be used to clean the bathroom.



**7. Voice Announcement.** Main product features and motions are notified by voice announcements. Pressing the voice icon allows you to operate and release the voice announcement function.





## 8. System Set-up Function. Ionizer adjustments and filter initializing.

### Volume Control

1. Change to the system setting mode by pressing the SET icon on the LCD for three seconds. The back light will be white on the MMP series. Voice message will say "System setup mode".
2. When the voice icon (volume control) is pressed for 1.5 seconds, a melody sounds and the voice icon blinks. Press F1 to raise volume. Press F2 to lower volume.
3. Voice announcement, whenever F1 or F2 is pressed, will say, "Voice function works". It will be announced with a changed voice volume. Volume level is indicated on status display icon.
4. When the desired volume is obtained, lightly press and hold blinking voice button for two beeps. It will say, "Setup was complete". Then press and hold set button for two beeps. It will again say, "Setup was complete". The back light will be green on MMP series. Voice message will say "Setup was completed."

### Adjusting Power Mode



1. Start at the green screen.
2. Hold down the SET button until it beeps two times; then let go. At this point the screen should turn white and the voice will say "System setup mode". If not, repeat this step until it turns white.
3. Hold down the button of the level that you want to adjust (Let's use Alkaline level 3, for example), until it beeps twice, then let go. Voice will say "Alkaline level three" and the button should be flashing. If not, repeat this step.
4. Locate the F1 and F2 buttons (pictures of filters). To increase the power press F1. To decrease power, press F2. You will see the levels increase or decrease on the status icon.
5. Hold down the "Alkaline number 3" button for two beeps. Button should stop flashing and bars on status icon should drop back down. Voice will say "Setup was complete".
6. Hold down the SET button again for two beeps. Voice will say, "Set up was complete". Screen should turn green again. If not, repeat until screen is green.

- For suggested power settings, please contact Tyent Service

## Other Icon Displays

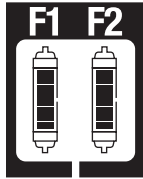

- 1. Filter F1, Filter F2.** Filter usage is displayed in percentage (%) letting you know when the filter needs to be replaced.
  - A. First Alarm:** Filter usage at 95% represented by a blinking light
  - B. Second Alarm:** Filter usage at more than 100% followed by a voice message: "Please replace filters"



- 2. Status Display Icon.**
  - A. Alkaline pH Level Display** indicates pH levels.
  - B. Voltage Level Display** (System Setting Function) indicates pH and volume levels.

TIME



- 3. Water outflow indicator** – shows the status while functional water is being produced.



**A. Shows** water production status.



**B. Shows** projected end-time for five minute cycle.

# TURBO Function

The TURBO Function, only in the **MMP-7070 TURBO** and **MMP-9090 TURBO EXTREME** models, allows you to create strong alkaline and acidic water. These types of water are **ONLY** to be used for cleaning, sanitizing and disinfecting purposes. **NEVER DRINK THESE TYPES OF WATER.**

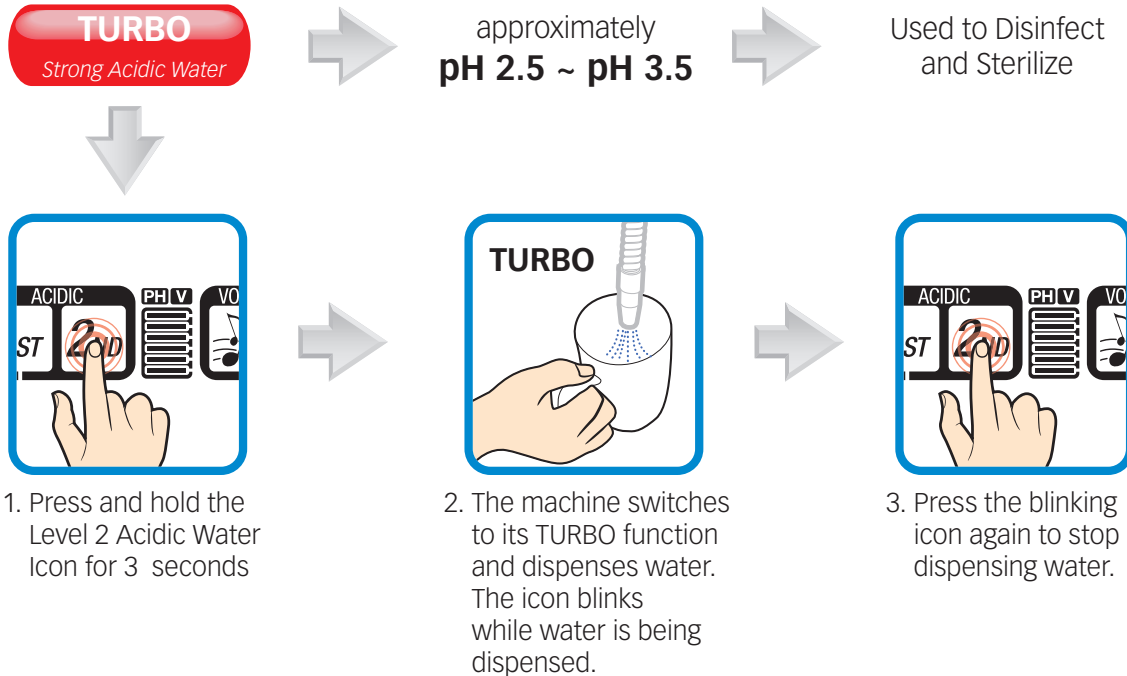

**While operating in the TURBO function, the machine automatically stops dispensing water after dispensing for 5 continuous minutes.**

**NOTE:** In areas of the country where source waters have above hardness values than normal, it may be necessary to slow the flow of the water through the machine in Turbo Acidic Mode to achieve lower acidic pH values. This will allow the unit to perform a much higher degree of separation between alkaline and acidic minerals.

**TURBO**  
Strong Alkaline Water

approximately  
**pH 10.0 ~ pH 12.0**

To remove stains from  
fabrics/carpet/upholstery.



1. Press and hold the  
Level 3 Alkaline  
Water Icon for 3  
seconds

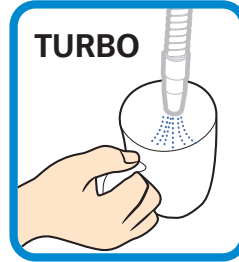

2. The machine switches  
to its **TURBO** function  
and dispenses water.  
The icon blinks  
while water is being  
dispensed.

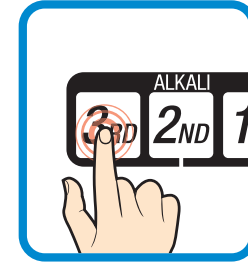

3. Press the blinking  
icon again to stop  
dispensing water.

## Caution



The waters produced in **TURBO** mode are not intended for drinking.

**DO NOT DRINK** these types of waters.

**DO NOT** Use the **TURBO** function in a manner other than directed.

The unit's pH levels and ultimate water quality will vary greatly based on source water, mineral quality, location, temperature, time and other factors.

## Customer Serviceable Parts

**ATTENTION:** The consumer accepts any and all responsibility and/or liability if replacement filters and/or parts are not manufacturer specific. This unit contains high-performance purifying filters and an advanced control system.

Primary Filter: **ACF Filter TY-2004**

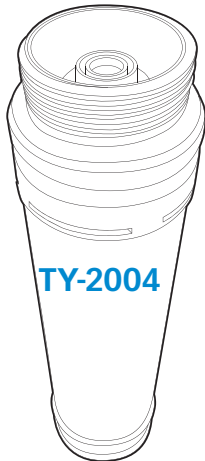

**Recommended filter replacement cycle:**

951.0 gallons (3,600 L) /  
Every 6 months

**Activated Carbon Fiber Filter** Removes odors and enhances flavor.

Secondary filter: **Ceramic Filter TY-2004**

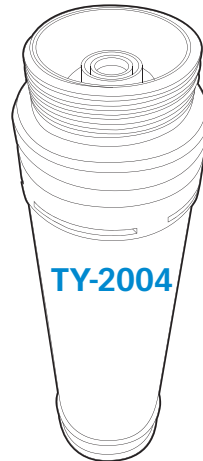

**Recommended filter replacement cycle:**

951.0 gallons (3,600 L) /  
Every 6 months

**Activated Carbon Fiber Filter** Removes odors and enhances flavor.

**Ceramic Filter** is rich in minerals and provides excellent heat conductivity. This helps dissolve nutrients which speeds up metabolism.

The life of the filter may vary greatly due to use, water pressure, water quality and seasonal changes. Filters may need to be replaced sooner than the scheduled time due to these varying conditions, as you may notice reduced water quality or water taste changing for the worse.

## How to Change the Filters

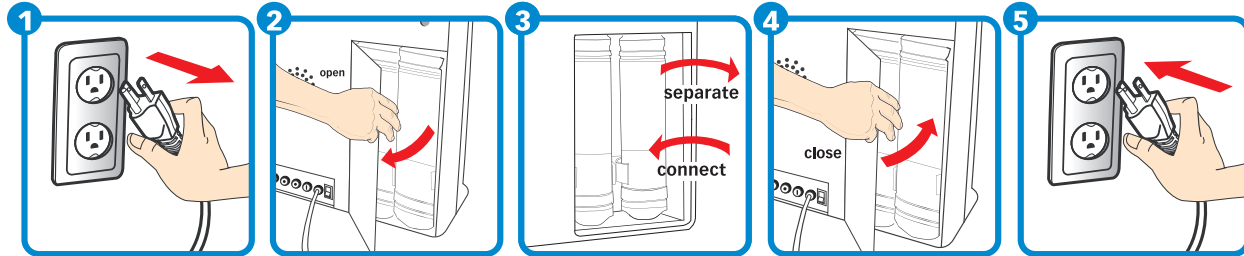

1. Turn the power off and unplug the power cord. Shut off the water supply to the unit. Make sure the faucet is shut off.
2. Open the filter door on the back of the unit. Beware of the sharp corners of the cover of the unit when opening.
3. Remove the filter by rotating the filter clockwise. Install the new filter by turning it counter-clockwise.
4. Close the cover of the unit.
5. Plug the power cord back in, re-engage the water supply and switch the unit back on.

## How to Reset the filters

1. Press the system setup icon for 3 seconds. A voice message will say "System setup mode".
2. After replacing the first filter, press the F1 icon once. A voice announcement will say "1st filter." Press the F1 icon again. A voice announcement will say "initializing was performed".
3. After replacing the second filter, press the F2 icon once. A voice announcement will say "2nd filter." Press the F2 icon again. A voice announcement will say "initializing was performed".
4. Press the system setup icon for 3 seconds. A voice message will say "Setup complete". The water outflow selection mode is available for operation.

**NOTE:** For turbo models, do not enter setup mode to reset filter life indicator. Simply press each filter button twice.



## How to Change the Fuse

1. Unplug the power cord.
2. Locate the fuse cap on the lower back of the unit and turn it counter-clockwise to remove it.
3. Pull out the blown fuse and insert a new fuse.
4. Replace the fuse cap.

## Important Information



Please request that a qualified service repair person replace the fuse with a manufactured fuse. The consumer accepts all responsibility for any unit failures and malfunctions if non-manufacturer specific parts are used.

## Cleaning your Tyent Unit

Your Tyent MMP Series Water Ionizer has 2 modes of cleaning: **Automatic** and **Manual**.

1. Auto-cleaning function lasts 15 seconds and is performed during water outflow after more than 12 hours of non-operation, after 30 liters (7.9 gallons) of water outflow or each time the power is turned off and on. The unit will blink between purple and red as an indication of the Cleaning Cycle Mode. Press Alkaline 1, 2 or 3 to start cleaning. After 15 seconds, the water mode selected will be dispensed. A distinct melody will be heard during this process. To stop flow of water, simply push the same button again.
2. Manual cleaning function lasts 15 seconds and can be manually set to clean the unit whenever desired. Simply touch RTR icon. (Real Time Refresh). **NOTE:** Should you wish to discontinue cleaning during the process, simply touch the RTR icon again.

Do not attempt to drink water discharged during the cleaning process!

## Recommendations for using this unit

Glass or approved metal containers may be used to store alkaline water. For the best results, store in an airtight container in the refrigerator. For the highest quality of alkaline water, drink within one day. Some benefits can be derived for up to three days.

### Acidic Water

- 1. Hand and face washing:** If you have your hands in and out of water a lot during the day, the neutral pH of most tap water, along with the use of soap can dry and age the skin. Using acidic water disinfects and nourishes the skin. It has astringent properties as well and can help prevent acne.
- 2. Hair Washing:** The astringent properties of acidic water will neutralize the soap residue on the hair. Your hair will have a high polish.
- 3. Shaving:** Using acidic water during and after shaving will have disinfectant and astringent effects with no discomfort.
- 4. For Use in the mouth:** Massage gums with acidic water to soothe inflammation from teething or mouth sores. Gargle with it to help with a sore throat.
- 5. For disinfecting the kitchen:** Use to wash down countertops, cutting boards and utensils to kill bacteria.
- 6. Disinfecting and healing the skin:** The pH of the skin is acidic; therefore, the use of acidic water on the exterior of the body has a healing effect. The acidic water has disinfectant properties as well as styptic properties. Cuts and burns will heal faster if cleaned with acidic water. A poultice soaked in acidic water may also be used for boils and other skin eruptions.
- 7. Flower enhancement:** Acidic water extends the life of cut flowers.



## Alkaline Water

Drink a recommended amount of alkaline water each day. If no negative symptoms are experienced, a higher pH may slowly be incorporated.

Occasionally a first-time drinker may notice an unusual smell associated with the alkaline water. It has been described as a smell similar to disinfectant by some and a smell similar to soil by others. Some have actually experienced nausea. Although this is rare, be assured that the water is safe to drink and is healthy. You will quickly adjust to the unique properties of the alkaline water.

- 1. Cooking Rice:** Makes great rice! First wash rice with acidic water. Then soak it in alkaline water for 30 to 60 minutes. When the rice is completely cooked, it becomes nice tasting rice with a good polish similar to cooked glutinous rice. Rice cooked in alkaline water also remains fresh for a longer period of time.
- 2. Making Coffee and Tea:** Alkaline water makes wonderful coffee and tea. It takes away the acidity and leaves the fine aroma and taste. Tea may be made in room temperature alkaline water.
- 3. As an Emulsifier:** It breaks down fat and removes odor. It is good to soak meats in alkaline water to remove the smells of fat and fish. Soak meats and fish for 20-30 minutes.
- 4. Fresher Fruits and Vegetables:** Great for cleaning fresh fruits and vegetables in the alkaline water as it takes off the wax and pesticide sometime left on the surface. It also preserves the fruit / vegetables for a longer period of time.
- 5. Help with Hangovers:** Reduce unpleasant after effects of overeating / over drinking by drinking alkaline water before going to sleep and/or on an empty stomach first thing in the morning.
- 6. For refreshment:** Try an alkaline water ice cocktail. It is soft, smooth and thirstquenching.
- 7. For treating animal parasites:** Parasites cannot thrive in an alkaline environment. Alkaline water is super hydrating and it helps the body purge and heal faster.



# Troubleshooting

Before requesting service, please make sure to check the following:

## 1. Water tastes abnormal

- A. Check how long the unit has not been in use
  - i. Operate the unit normally for a few minutes to drain stagnant water.
- B. Check to see if the filters need replacing.
  - i. Call to have the filter replaced.

## 2. NO water outflow or the amount of water generated is different from specified

- A. Be sure the water supply is on
  - i. Open the valve
- B. Check if the hose is bent or folded
  - i. Stretch out the hose
- C. Check to see if the flow rate is sufficient
  - i. Contact the service center to install a water pump
- D. Check the purifying filter for clogs
  - i. Replace filter

## 3. Incorrect pH levels (additional pH reagent drops can be ordered for a fee)

- A. Check water supply for hardness
  - i. pH levels may vary depending on region and water quality
- B. Check flow rate for higher levels
  - i. Slow down water supply

## 4. The filter replacement icon remains turned on even after filter has been replaced

- A. Follow the filter reset instructions
  - i. Contact the service center to initialize the filter flow rate in the System Setting Mode



## 5. The unit automatically stops while it's producing functional water

- A. Check if the continuous operating time exceeds 5 minutes
  - i. Water production stops automatically after 5 minutes to prevent accidental over flooding

## 6. Leaks from the Filter or Unit

- A. Check the filter is installed correctly
- B. Check the inside of the product (excluding the filters) for any signs of leaks
  - i. Immediately unplug the power cord and contact the service center
  - ii. Be sure all hoses are firmly seated in correct connections

## 7. Hazy substance settles down on the bottom of the container filled with functional water

- A. Check if calcium ions and carbonic acids bond together in water forming deposits
  - i. Depending on the quality of raw water, calcium is extracted from the water. There is no problem in drinking water with calcium. However, it is recommended that you contact the service center in case it is a recurring problem.

## 8. Only purified water is extracted.

- A. Check if flow rate is low (1kgf/cm<sup>2</sup> or slower.)
  - i. Contact us to install a pressurized pump.
- B. Check if flow rate is high. (5kgf/cm<sup>2</sup> or faster.)
  - ii. Contact us to install a pressure reducing valve.

## 9. The unit doesn't operate in cleaning mode

- A. Check if the amount of working water exceeds 7.9 gallons (30 L)
- B. Check if the operating time exceeds 12 hours
- C. Check if the cleaning button is pressed
  - i. The unit returns to normal after performing auto cleaning for 15 seconds





Notes

---

---

---

---

---

---

---

---

---

---

---

---

---

---

---

---

---

---

---

---

---



- The consumer accepts any and all responsibility and/or liability if replacement filters and/or parts are not manufacturer specific.
- This product is subject to changes that enhance its performance without prior notification.

### pH Chart

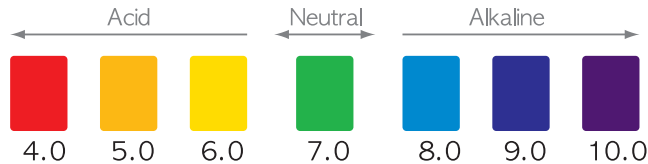

**How to Measure:** Place 10-15 ml of test water in a container and add 2-3 drops of reagent. Then, mix well and check color of the water with the pH chart above. (Color is dependent on water quality and reagent)

**MADE IN KOREA**



Tyent USA, LLC.  
855-TYENT-USA (893-6887)  
[www.tyentusa.com](http://www.tyentusa.com)